

COLD STORAGE FACILITY FOR SALE/LEASE

1044 KEYSTONE BLVD | POTTSVILLE, PA

TRI-TEMP DISTRIBUTION CENTER | 147,950 SF

Colliers
INTERNATIONAL

PROPERTY STATISTICS

- » Total Building: 147,950 SF
 - » Dry Grocery: 51,200 SF
 - » Freezer Area: 41,165 SF
 - » Cooler Area: 16,625 SF
 - » Office: 6,365 SF
- » Clear Height: 40'-45' clear
- » Year Built: 2009
- » Dock Doors: 11 DH; 1 DI
- » Location: Approx 1 mi to I-81
- » Condition: Facility and roof in excellent overall condition

REFRIGERATION

- » Temps capable of -10°F, +28°F, +32°F, 50°F
- » Ammonia system w/ glycol heated floor in freezers & 28°F meat cooler
- » Cold dock areas capable of 38°F



FOR MORE INFORMATION, PLEASE CONTACT EXCLUSIVE AGENTS:

Food Advisory Specialists

Chris Cummings
chris.cummings@colliers.com
Dir +1 404 877 9255

Turner Wisehart
turner.wisehart@colliers.com
Dir +1 404 574 1008

Local Market Experts

Michael Zerbe
michael.zerbe@colliers.com
Dir +1 610 684 1853

Mark Chubb
mark.chubb@colliers.com
Dir +1 610 684 1862

This document has been prepared by Colliers International for advertising and general information only. Colliers International makes no guarantees, representations or warranties of any kind, expressed or implied, regarding the information including, but not limited to, warranties of content, accuracy and reliability. Any interested party should undertake their own inquiries as to the accuracy of the information. Colliers International excludes unequivocally all inferred or implied terms, conditions and warranties arising out of this document and excludes all liability for loss and damages arising there from. This publication is the copyrighted property of Colliers International and/or its licensor(s). ©2015. All rights reserved.

COLD STORAGE FACILITY FOR SALE/LEASE

1044 KEYSTONE BLVD | POTTSVILLE, PA

TRI-TEMP DISTRIBUTION CENTER | 147,950 SF



SUBJECT PHOTOS AND FEATURES

General Building Info:

- » 147,950 SF
- » ±43.72 AC
- » Office/Employee Welfare: 6,356 SF
- » Machine/Electrical/Controls: 4,820 SF
- » Pallet Positions: 21,157
- » Parking:
 - » ± 110 vehicle
 - » ± 55 trailer (ability to expand)
- » Fully sprinklered; 3,000 gpm fine water pump

Backup Power System:

- » 600 KW generator
- » 175 gallon diesel tank
- » 48 hour run time per tank
- » Sound attenuated low noise



Racked Storage



Interior Pit Levelers

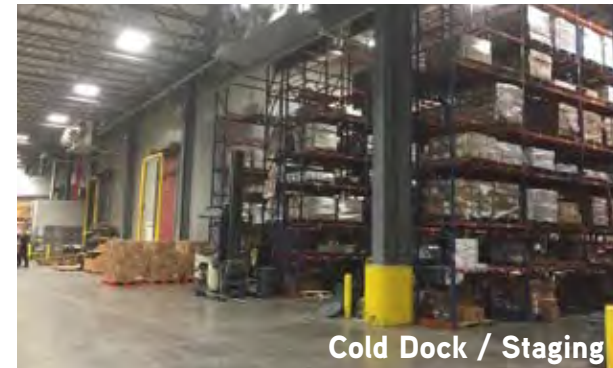

Cold Dock / Staging



Break Area



Exterior

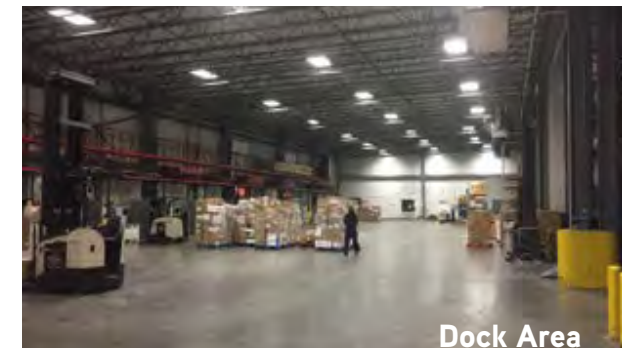

Dock Area

COLD STORAGE FACILITY FOR SALE/LEASE

1044 KEYSTONE BLVD | POTTSVILLE, PA

TRI-TEMP STORAGE & DISTRIBUTION CENTER | 113,450 SF



Floor Plan and Statistics

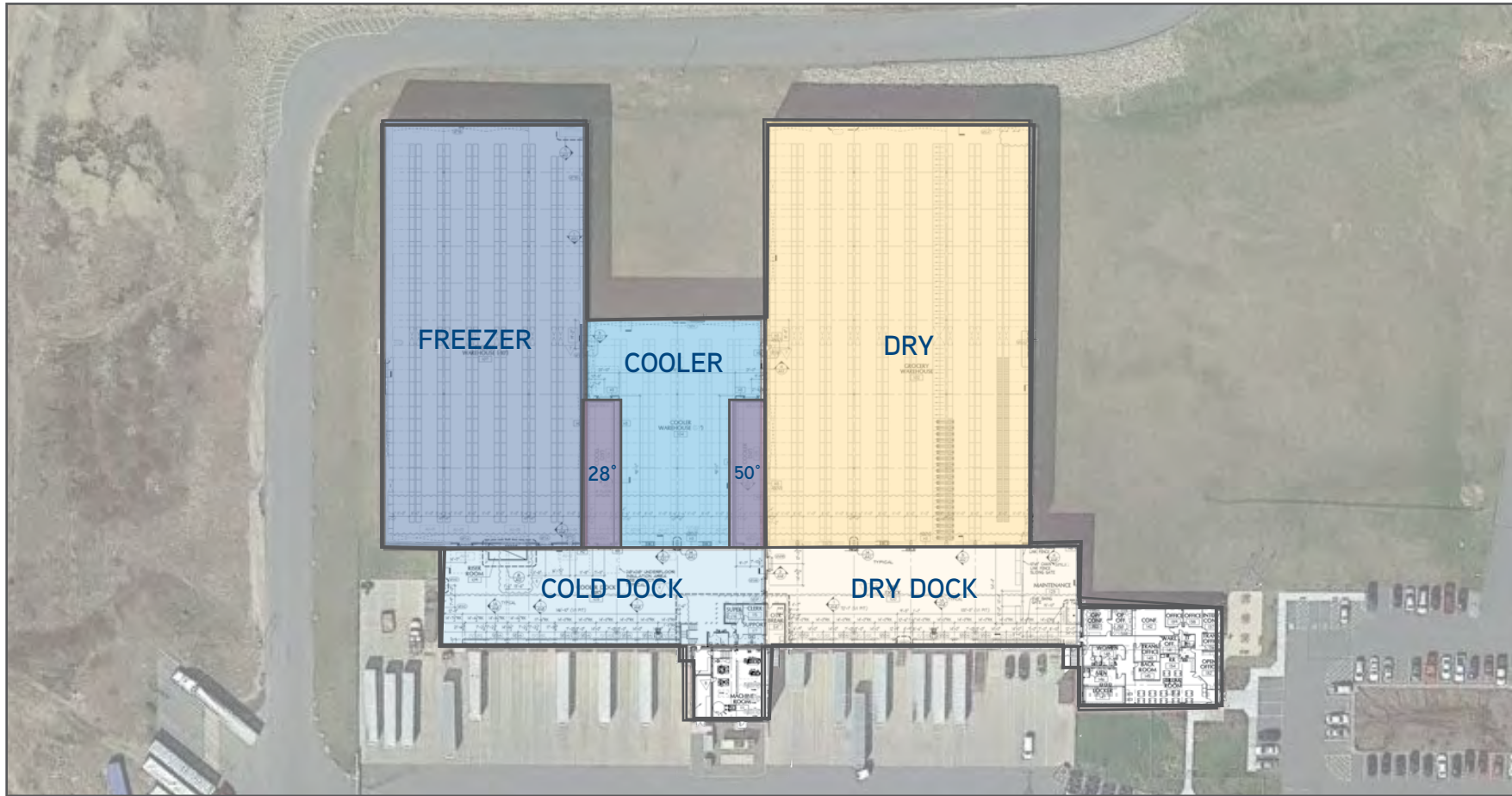

	FREEZER STORAGE	28° COOLER	50° COOLER	COOLER STORAGE	DRY STORAGE	COLD DOCK	DRY DOCK
Total Size:	39,015 SF	2,150 SF	2,150 SF	14,475 SF	51,200 SF	14,475 SF	12,315 SF
Clear Height:	40'	40'	40'	40'	45'	24'	24'
Dimensions:	(D) 248' x (W) 137'	(D) 100' x (W) 19'	(D) 100' x (W) 19'	(D) 150' x (W) 121'	(D) 284' x (W) 174'	(D) 70' x (W) 158'	(D) 70' x (W) 165'
Area Temp.:	-10° F	28° F	50° F	32° - 38° F	Ambient	38°	Ambient
Pallets:	6,960	344	344	2,520	10,989	-	-
DH Doors:	-	-	-	-	-	6	5

COLD STORAGE FACILITY FOR SALE/LEASE

1044 KEYSTONE BLVD | POTTSVILLE, PA

TRI-TEMP DISTRIBUTION CENTER | 147,950 SF

Colliers
INTERNATIONAL

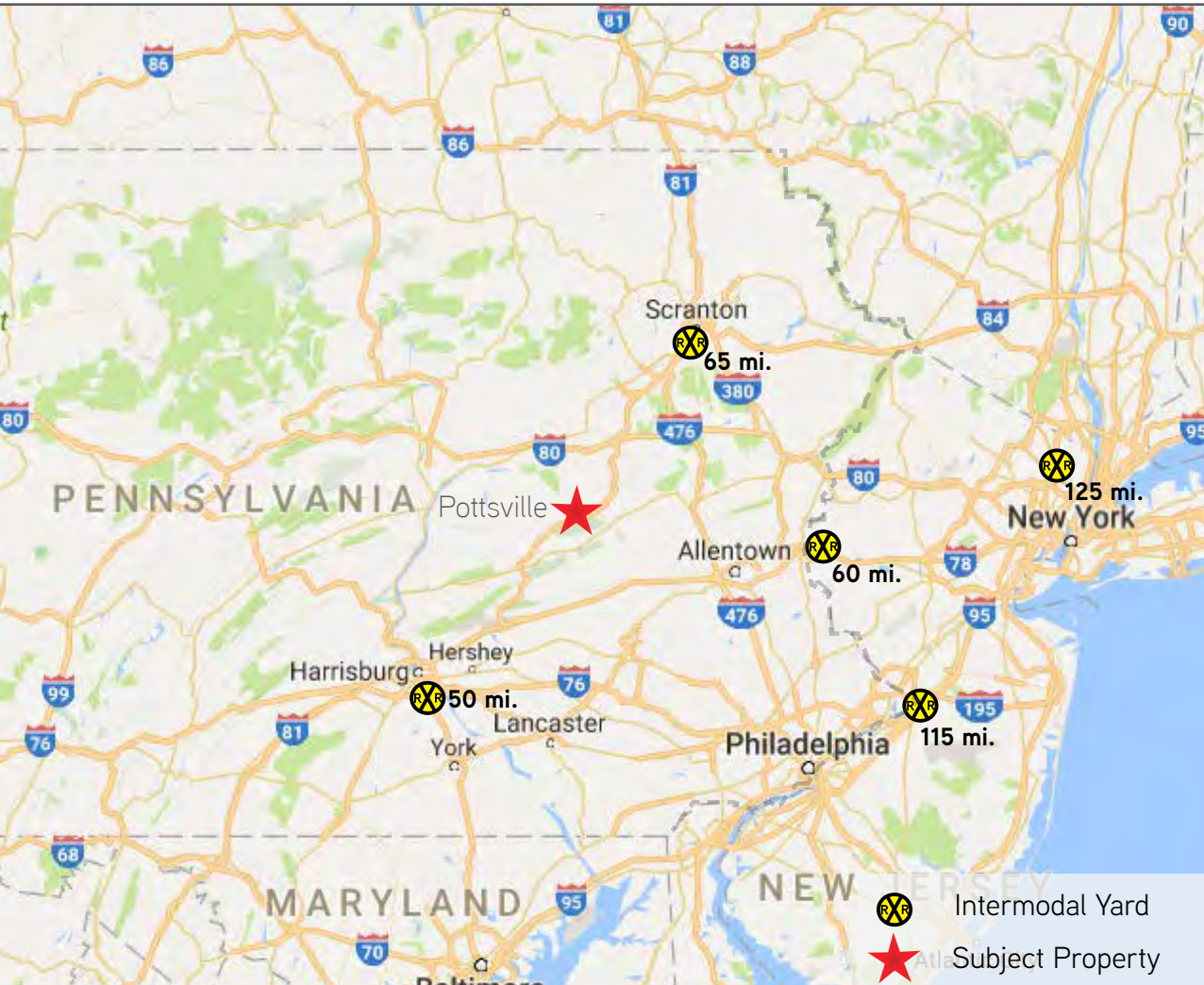

Location:

1044 Keystone Blvd is strategically located off Exit 116 and Exit 119 of I-81 in Schuylkill County. The building is located in the Schuylkill Highridge Business Park, a 2,000 acre master planned development by the Schuylkill Economic Development Corporation (SEDCO). Highridge Business Park draws workers from a labor-shed of Schuylkill and 8 neighboring counties. With easy access via I-81, 1044 Keystone is the ideal location for employers that demand a large workforce with diverse skill sets. Other major employers within the park include Walmart, Wegman's, Sara Lee/Hillshire Brands, Lowe's, Jeld-Wen, and Hudson Bay Company (parent company of Saks 5th Avenue and Lord & Taylor).

FROM SUBJECT TO:	DRIVE TIME
Allentown, PA	1 hr 11 mins
Harrisburg, PA	1 hr 11 mins
Philadelphia, PA	2 hr 23 mins
Baltimore, PA	2 hr 34 mins
New York, NY	2 hr 57 mins
Washington, DC	3 hr 41 mins
Boston, MA	6 hr 12 mins

FOR MORE INFORMATION, PLEASE CONTACT EXCLUSIVE AGENTS:

Food Advisory Specialists

Chris Cummings
chris.cummings@colliers.com
Dir +1 404 877 9255

Turner Wisheart
turner.wisheart@colliers.com
Dir +1 404 574 1008

Local Market Experts

Michael. Zerbe
michael.zerbe@colliers.com
Dir +1 610 684 1853

Mark Chubb
mark.chubb@colliers.com
Dir +1 610 684 1862

COLD STORAGE FACILITY FOR SALE/LEASE

1044 KEYSTONE BLVD | POTTSVILLE, PA

TRI-TEMP DISTRIBUTION CENTER | 147,950 SF



1044 Keystone Boulevard,
Pottsville, PA 17901

FOR MORE INFORMATION, PLEASE CONTACT EXCLUSIVE AGENTS:

Food Advisory Specialists

Chris Cummings
chris.cummings@colliers.com
Dir +1 404 877 9255

Turner Wisehart
turner.wisehart@colliers.com
Dir +1 404 574 1008

Local Market Experts

Michael. Zerbe
michael.zerbe@colliers.com
Dir +1 610 684 1853

Mark Chubb
mark.chubb@colliers.com
Dir +1 610 684 1862